

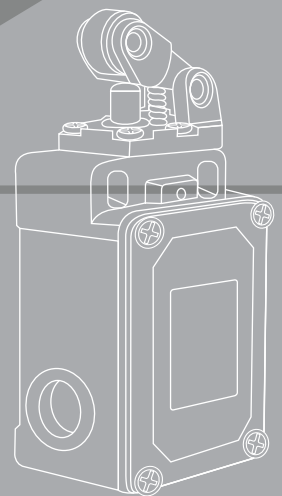

AN ISO 9001 : 2015 CERTIFIED COMPANY
PRICE LIST W.E.F. 01/01/2021

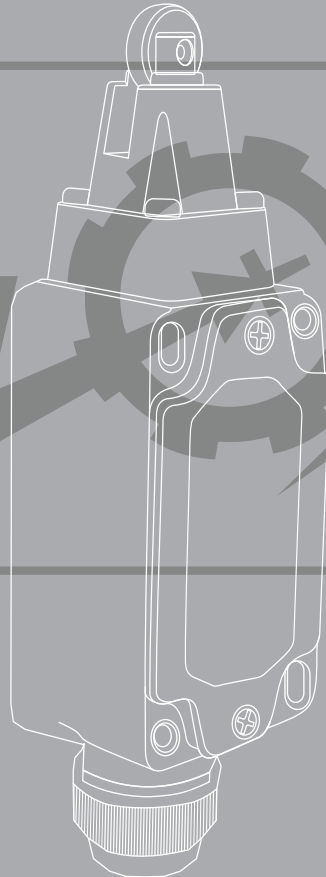
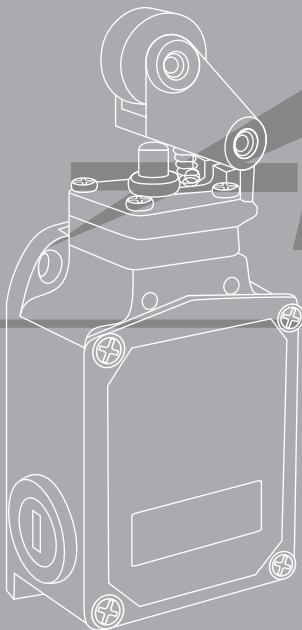
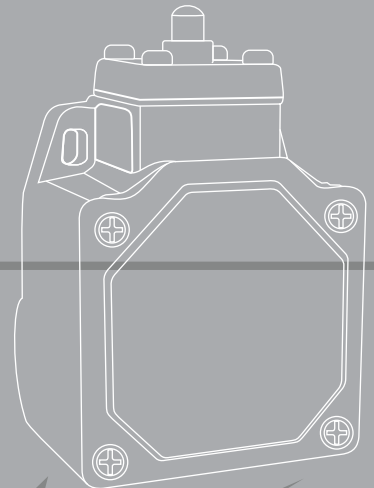
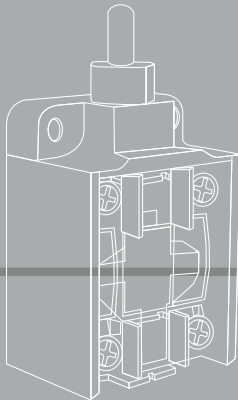
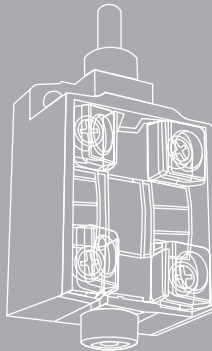
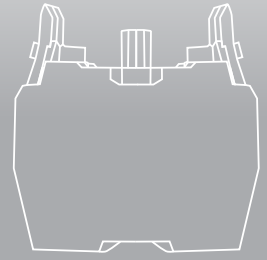
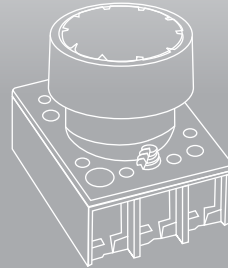
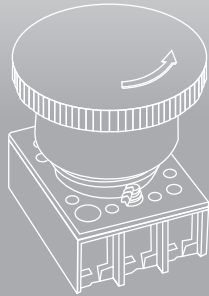
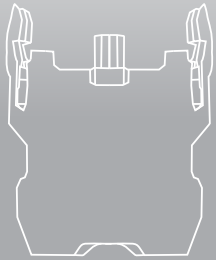

Manufactured By:

AVON SWITCHGEARS PVT. LTD.

Unit No. 10, Hakoba Industrial Estate, I.B.Patel Road, Goregaon East, Mumbai-400063.

☎ 022-26861079 / +91-9930710951 ✉ avonswitchgears@gmail.com

🌐 www.avonswitchgears.in

DEALERS ENQUIRIES SOLICITED



®

CE

AVON SWITCHGEARS PVT. LTD.

AN ISO 9001 : 2015 CERTIFIED COMPANY

ITEMS	NO.	DESCRIPTION	TYPE	STD. PKD.	UNIT RATE (₹)
-------	-----	-------------	------	-----------	---------------

REMOTE CONTROL UNITS (TYPE - 4) CUT - OUT DIA. 22.50 M.M.

ACTUATORS



1	Push Button Standard (Shrouded / Unshrouded)	PBS-4 S/U ■ ■ ■ ■ ■	20	44.00
2	Push Button Luminous (Shrouded / Unshrouded)	PBL-4 S/U ■ ■ ■ ■ ■ ■ ■	20	48.00
3	Push Button Mushroom	PBM-4 ■ ■ ■	20	48.00
4	Stay Put Actuator (Press to Lock Rotate to Reset)	STP-4	20	88.00
5	Selector Actuator (2 Position Momentary / Maintained)	SLT-4 A/B ■ ■	20	125.00
6	Selector Actuator (3 Position Momentary / Maintained)	SLT-4 C/D ■ ■	20	125.00
7	Key Selector Actuator Specify Locking Position (ON/OFF/2P)	PBK - 4 A/B/C	10	385.00
8	Key Emergency Stop Actuator (Press to Lock Key to Reset With Mushroom Knob)	PBKR-4	10	360.00
9	Pilot Lens Assembly	PLA-4 ■ ■ ■ ■ ■ ■ ■	20	38.00

Above Items Are With Regular Plastic Holder For Rear Connection Components. For Front Connection Components: Specify Metal Holder. Same Are Available Without Any Holder At List Price Reduced By ₹ 5.00.

REAR CONNECTION

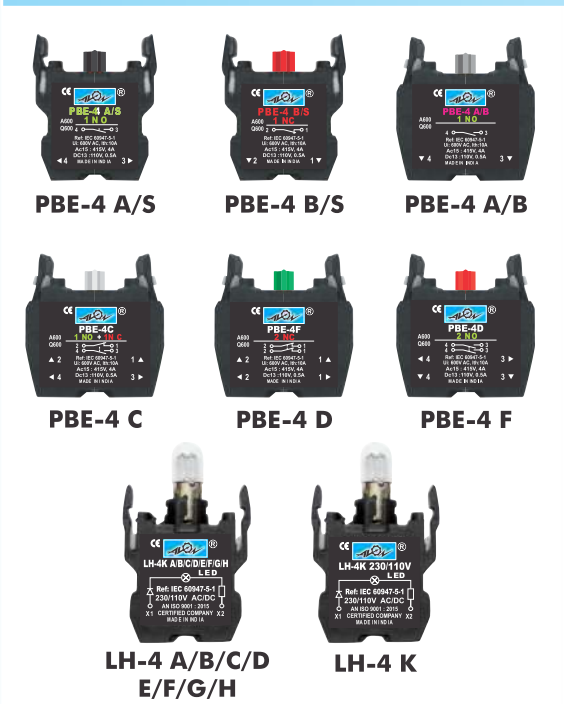

10	Contact Elements			
	1 NO / 1 NC (Small)	PBE-4 A/S or B/S	20	52.00
	1 NO / 1 NC (Regular)	PBE-4 A/B	20	60.00
	1 NO + 1 NC / 2 NO / 2 NC	PBE-4 C/D/F	20	85.00
11	Lamp Holders			
	6 V AC/DC Supply 6 V Lamp	LH-4 A	20	54.00
	12 V AC/DC Supply 12 V Lamp	LH-4 B	20	54.00
	24 V AC/DC Supply 24 V Lamp	LH-4 C	20	54.00
	130 V AC/DC Supply 130 V Lamp	LH-4 D	20	62.00
12	Lamp Holders With Built- in Resistor			
	6 V AC/DC Supply 6 V Lamp	LH-4 E	20	62.00
	12 V AC/DC Supply 12 V Lamp	LH-4 F	20	62.00
	24 V AC/DC Supply 24 V Lamp	LH-4 G	20	62.00
	130 V AC/DC Supply 130 V Lamp	LH-4 H	20	68.00
13	Lamp Holders With Built-in Resistor & Rectifier	LH-4 K	20	84.00
	230/240 V 50 Hz Supply (Including 130 V Lamp)			



®

CE

AVON SWITCHGEARS PVT. LTD.

AN ISO 9001 : 2015 CERTIFIED COMPANY

ITEMS	NO.	DESCRIPTION	TYPE	STD. PKD.	UNIT RATE (₹)
-------	-----	-------------	------	-----------	---------------

REAR CONNECTION



14	Lamp Holders With Voltage Reducer Block	LH-4M	20	135.00
	220 V DC (Including 130 V Lamp)			
15	L.E.D. Lamps			
a.	Lamp Holders with L.E.D. Lamp			
	230 V AC/ 110 V AC Only	LH-4LD/230/110 AC	20	120.00
	220/ 110 V DC	LH-4LD/220/110 DC	20	120.00
	6/12/24/48 V AC or DC	LH-4LD/6/12/24/48 AC/DC	20	98.00
b.	L.E.D. Bulb			
	(with E10/BA9 caps specify requirement)			
	6/12 V AC or DC	LB-6/12-E/B-AC/DC	50	28.00
	24 V AC or DC	LB-24-E/B-AC/DC	50	35.00

FRONT CONNECTION

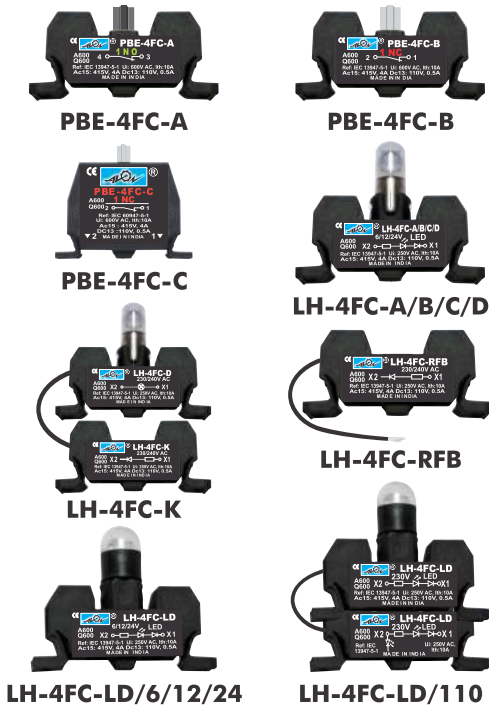

16	Contact Elements			
	1 NO/ 1 NC	PBE-4FC-A/B	20	52.00
	1 NO+ 1 NC	PBE-4FC-C	20	85.00
17	Lamp Holders			
	6/12/24 V AC/DC Supply	LH-4FC-A/B/C	20	52.00
	110 V AC/DC Supply	LH-4FC-D	20	61.00
	(Including 130 V Lamp)			
18	Lamp Holders with External Rectifier Block	LH-4FC-K	8	85.00
	230/240 V, 50 Hz Supply			
19	Rectifier Blocks	LH-4FC-RFB	20	48.00
	230/240 V, 50 Hz Supply (Used in series with lamp holder LH-4 FC-D)			
20	Lamp Holders with L.E.D. Lamps			
	6/12/24 V AC/DC (Specify Voltage)	LH-4FC-LD/6/12/24	20	98.00
	110/230 V AC/DC	LH-4FC-LD110/230 AC/DC	8	122.00
	(With External Rectifier Block)			
	110/230 V AC	LH-4FC-LD/110/230 AC	8	122.00
	(With External Rectifier Block)			

PUSH BUTTON STATION (In Aluminium Enclosures)



21	1 Way (Stay Put Actuator with NC Contact Element)	PB. STN.-4/1W	1	745.00
22	2 Way (Red push Button with NC Contact Element & Green Push Button with NO Contact Element)	PB. STN.-4/2W	1	805.00
23	3 Way (3- Push Buttons Each with Single Contact Element)	PB. STN.-4/3W	1	1090.00

SPARES FOR 22.5 MM. SERIES-4



24	Knob for Push Button			
	Standard-Shrouded/Unsrouded	PBS-4/KN-S/U	50	11.00
	Luminous-Shrouded/Unsrouded	PBL-4/KN-S/U	50	16.00
	Mushroom	PBM-4/KN-M	50	16.00



®

CE

AVON SWITCHGEARS PVT. LTD.

AN ISO 9001 : 2015 CERTIFIED COMPANY

ITEMS	NO.	DESCRIPTION	TYPE	STD. PKD.	UNIT RATE (₹)
-------	-----	-------------	------	-----------	---------------

SPARES FOR 22.5 MM. SERIES-4



ADP-4



PLA-4 CAP



TC-4



TP-4



MR-4/4



MR-4/7



RP-4



BP-4



RRP-4

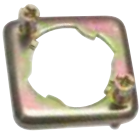

MH-4



B/6V/12V/24/130V

25	Adaptor Plate	ADP-4	50	22.00
26	Cap only for Lens Assembly	PLA-4 CAP [Color Swatches]	50	20.00
27	Thrust Cap for Push Buttons	TC-4	50	8.00
28	Thrust Pad for Selector	TP-4	50	6.00
29	Metal Rail (For Front Connection Components)			
	4-Way	MR-4/4	50	10.00
	7-Way	MR-4/7	50	17.00
30	Reduction Plate (Set of 2)	RP-4	50	18.00
31	Blanking Plug	BP-4	50	15.00
32	Metal Holder (For Front Connection Push Button)	MH-4	50	18.00
33	Bulbs			
	6V/12V/24V	B/6V/12V/24V	50	15.00
	130V	B/130V	50	20.00
34	Relay Reset Plunger	RRP-4	50	18.00

REMOTE CONTROL UNITS (TYPE - 5) CUT - OUT DIA. 22.50 M.M.

ACTUATORS



PBS-5/S (P)



PBS-5/U (P)



PBL-5 S/U (P)



PBM-5 (P)



PBM-5 (M)



STP-5 (P)



STP-5 (M)



PBKR-5



PBK-5 A/B/C /D/E (P)/(M)



SLT-5 A/B/C/D



PLA-5 (P)

1	Push Button Standard- Plastic (Shrouded/Unshrouded)	PBS-5 S/U (P) [Color Swatches]	20	44.00
2	Push Button Luminous- Plastic (Shrouded/Unshrouded)	PBL-5 S/U (P) [Color Swatches]	20	48.00
3	Push Button Mushroom- Plastic/Metal	PBM-5 (P) [Color Swatches] PBM-5 (M) [Color Swatches]	20	77.00
4	Stay Put Actuator- Plastic/Metal	STP-5 (P) STP-5 (M)	20	88.00
5	Emergency Stop (Press to lock key to reset)	PBKR-5	10	385.00
6	Key Selector Actuator			
	2 Position (Specify Locking Position-Left/Right/Both)	PBK-5 A/B/C (P) PBK-5 A/B/C (M)	10	330.00
	3 Position (Specify Locking Position-Center/Left & Right)	PBK-5 D/E (P) PBK-5 D/E (M)	10	330.00
7	Selector Actuator Standard- Plastic			
	2 Position (Momentary/Maintained)	SLT-5 A/B (P)	20	125.00
	3 Position (Momentary/Maintained)	SLT-5 C/D (P)	20	125.00
8	Pilot Lens Assembly	PLA-5 (P) [Color Swatches]	20	44.00

Above Items Are With Regular Plastic Holder For Rear Connection Components. For Front Connection Components: Specify Metal Holder. Same Are Available Without Any Holder At List Price Reduced By ₹ 5.00.



®

CE

AVON SWITCHGEARS PVT. LTD.

AN ISO 9001 : 2015 CERTIFIED COMPANY

ITEMS	NO.	DESCRIPTION	TYPE	STD. PKD.	UNIT RATE (₹)
-------	-----	-------------	------	-----------	---------------

REAR CONNECTION



PBE-5 A



PBE-5 B



LH-5 A/B/C/D /E/F/G/H/K



LH-5 LD/6/12/24 110/230 AC/DC



IL-5 A/B/C/D/E/F/G/H/K



IL-5LD 6/12/24/110/230 AC/DC
IL-5LD/110/230 AC



IPB-5-S/U-A/B/C/D/E/F/G/H/K



IPB-5LD-S/U-6/12/24/110/230 AC/DC
IPB-5LD-S/U-110/230 AC

9	Contact Elements 1 NO/1 NC	PBE-5 A/B	50	52.00
10	Lamp Holders			
	6/12/24/110 V AC/DC (Without Series Resistance)	LH-5 A/B/C/D	10	75.00
	6/12/24/110 V AC/DC (With Series Resistance)	LH-5 E/F/G/H	10	80.00
	230/240 V 50 Hz Supply (With Series Resistance & Rectifier)	LH-5 K	10	80.00
11	L.E.D. Lamps			
	a. Lamp Holders with L.E.D. Lamps			
	6/12/24 V AC/DC	LH-5 LD/6/12/24	10	98.00
	110/230 V AC/DC	LH-5 LD/110/230 AC/DC	10	120.00
	110/230 V AC	LH-5 LD/110/230 AC	10	120.00
12	Indicating Light with Filament Lamps (Pilot Lens Assembly+Lamp Holder)			
	6/12/24/110 V AC/DC (Without Series Resistance)	IL-5 A/B/C/D	10	130.00
	6/12/24/110 V AC/DC (With Series Resistance)	IL-5 E/F/G/H	10	140.00
	230/240 V, 50 Hz supply (With Series Resistance & Rectifier)	IL-5 K	10	140.00
13	Indicating Light with LED Lamps (Pilot Lens Assembly+ LED Lamp Holder)			
	6/12/24 V AC/DC	IL-5LD/6/12/24 AC/DC	10	150.00
	110/230 V AC/DC	IL-5LD/110/230 AC/DC	10	170.00
	110/230 V AC	IL-5LD/110/230 AC	10	170.00
14	Luminous Push Buttons With Indicating Filament Lamps & Without Contact Element (Illuminated Push button + Lamp Holder)			
	6/12/24/110 V AC/DC (Without Series Resistance)	IPB-5-S/U-A/B/C/D	10	145.00
	6/12/24/110 V AC/DC (With Series Resistance)	IPB-5-S/U-E/F/G/H	10	150.00
	6/12/24/110 V AC/DC (With Series Resistance & Rectifier)	IPB-5-S/U-K	10	150.00
15	Luminous Push Buttons With Indicating LED Lamps & Without Contact Element (Illuminated Push button + Lamp Holder)			
	6/12/24/110 V AC/DC	IPB-5LD-S/U-6/12/24	10	160.00
	110/230 V AC/DC	IPB-5LD-S/U-110/230	10	180.00
	110/230 V AC	IPB-5LD-S/U-110/230 AC	10	180.00

FRONT CONNECTION

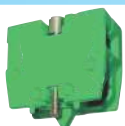

PBE-5FC- A



PBE-5FC- B

16	Contact Element 1 NO/1 NC	PBE-5FC- A/B	50	52.00
----	------------------------------	--------------	----	-------



®
CE

AVON SWITCHGEARS PVT. LTD.

AN ISO 9001 : 2015 CERTIFIED COMPANY

ITEMS	NO.	DESCRIPTION	TYPE	STD. PKD.	UNIT RATE (₹)
-------	-----	-------------	------	-----------	---------------

PUSH BUTTON STATION (In Aluminium Enclosures)



PB. STN.-5/1W PB. STN.-5/2W PB. STN.-5/3W

17	1 Way (Stay Put Actuator with NC Contact Element)	PB. STN.-5/1W	1	745.00
18	2 Way (Red Push Button with NC Contact Element & Green Push Button with NO Contact Element)	PB. STN.-5/2W	1	805.00
19	3 Way (3- Push Buttons Each with Single Contact Element)	PB. STN.-5/3W	1	1090.00

SPARES FOR 22.5 MM. SERIES-5



PLA-5/CAP RP-5 BP-5



MH-5 AD-5 (P)

20	Cap With Filter Only For Lens Assembly	PLA-5/CAP	50	25.00
21	Reduction Plate (Set of 2)	RP-5	50	18.00
22	Blanking plug	BP-5	50	15.00
23	Metal Holder (For Front Connection Push Button)	MH-5	50	18.00
24	Adaptor Plate For Rear Connection Holder (Plastic)	ADP-5 (P)	20	22.00

REMOTE CONTROL UNITS (TYPE - 3) CUT - OUT DIA. 30.50 M.M.

ACTUATORS



PBS-3 PBU-3 PBM-3/PBPP-3



PBK-3-ON/OFF/2P PBKM-3/PBKR-3



PBE-1 A/B PBE-1 C/D/E



PBM-3/KN-M

1	Actuator Shrouded	PBS-3	12	135.00
2	Actuator Unshrouded	PBU-3	12	140.00
3	Actuator Mushroom	PBM-3	12	158.00
4	Actuator Push Pull (Push to Operate Pull to Reset)	PBPP-3	12	190.00
5	Actuator Lockable (Specify Locking Position)	PBK-3-ON/OFF/2P	12	450.00
6	Actuator Lockable with Mushroom Knob-2P	PBKM-3	12	450.00
7	Actuator - Press to Lock - Key to Rest, with Mushroom Knob	PBKR-3	12	460.00
8	Contact Element			
	1 NO / 1 NC	PBE-1 A/B	10	90.00
	1 NO + 1 NC / 2 NO / 2 NC	PBE-1 C/D/E	10	110.00
9	Knob for Mushroom Actuator	PBM-3/KN-M	50	22.00



AVON SWITCHGEARS PVT. LTD.

AN ISO 9001 : 2015 CERTIFIED COMPANY

ITEMS	NO.	DESCRIPTION	TYPE	STD. PKD.	UNIT RATE (₹)
-------	-----	-------------	------	-----------	---------------

REMOTE CONTROL UNITS (TYPE - 2) CUT - OUT DIA. 30.50 M.M.

Actuators



1	Push Button Standard	PBS-2	20	98.00
		■ ■ ■ ■ ■		
2	Push Button Mushroom	PBM-2	20	114.00
		■ ■ ■		
3	Stay Put Actuator (Press to lock, Rotate to reset)	STP-2	20	185.00
4	Push Button Lockable (Specify Locking Position)	PBK-2-ON/OFF/2P	20	400.00
5	Push Button- Key Reset (Press to lock, key to reset with Mushroom Knob)	PBKR-2	20	400.00
6	Pilot Lens Assembly	PLA-2	20	100.00
		■ ■ ■ ■ ■		
7	Contact Element			
	a. Front Connection			
	NO or NC (Specify NO / NC)	PBE-2/FC-A/B	10	115.00
	1NO + 1NC / 2 NO / 2 NC	PBE-2/FC-C/D/E	10	130.00
	b. Rear Connection			
	NO or NC (Specify NO or NC)	PBE-2/RC-A/B	10	125.00
	1NO + 1NC / 2 NO / 2 NC	PBE-2/RC-C/D/E	10	140.00

SPARES FOR 30.50 MM SERIES

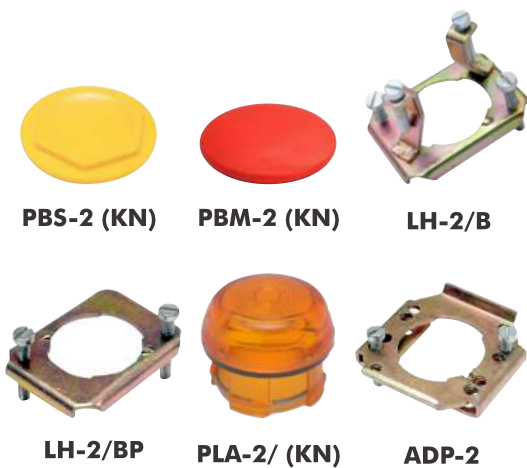

8	Knobs			
	Standard Push Button	PBS-2 (KN) ■ ■ ■ ■ ■	50	12.00
	Mushroom Push Button	PBM-2 (KN) ■ ■ ■	50	16.00
9	Brackets (For Contact Element)	LH-2/B	50	26.00
10	Brackets(Plates Only)	LH-2/BP	50	23.00
11	Lens Only(+Ring & Circlip)	PLA-2/ (KN)	50	23.00
12		ADP-2	50	32.00
	(For Using PBS-2 With PBE-1)			

NOTES

- ■ ■ ■ ■ Available In Red, Green, Blue, Amber, Milky & Clear Colours
- ■ ■ ■ ■ Available In Red, Green, Yellow, Blue & Black Colours
- ■ ■ Available In Red, Green & Black Colours
- ■ Available In Red & Black Colours



®

CE

AVON SWITCHGEARS PVT. LTD.

AN ISO 9001 : 2015 CERTIFIED COMPANY

ITEMS	NO.	DESCRIPTION	TYPE	STD. PKD.	UNIT RATE (₹)
-------	-----	-------------	------	-----------	---------------

LIMIT SWITCHES

TYPE-LSN / LS / ALS



LSN-001
LSN-011 LS-001
LS-011 ALS-001
ALS-011



LSN-102
LS-102
ALS-102
LS-102/3A/3B
LS-102/2A/2B
LSN-112
ALS-112



LSN-101
LS-101
ALS-101
LSN-101/3A/3B
LSN-101/2A/2B
LSN-111
ALS-111



LSN-202
LS-202
ALS-202
LS-202/3A/3B
LS-202/2A/2B
LSN-212
ALS-212



LSN-201
LS-201
ALS-201
LS-201/3A/3B
LS-201/2A/2B
LSN-211
ALS-211

1	Open Execution				
	(With Push Rod & Built Cover)				
	a. Normal				
	1NO+1 NC	LSN-001	10	125.00	
	1NO+1 NC	LS-001/ALS-001	10	125.00	
	1NO+1 NC (Overlapping)	LS-001/OL	10	140.00	
	2NO+1 NC/1 NO+2 NC	LS-001/3A/3B	10	205.00	
	2NO/2 NC	LS-001/2A/2B	10	160.00	
	b. Snap				
	1NO+1 NC	LSN-011/ALS-011	10	135.00	
	1NO+1 NC	ALS-011/2W	10	210.00	
2	With Standard Aluminium Housing				
	(Epoxy Powder Coated)				
	a. With Roller lever				
	Normal				
	1NO+1 NC	LSN-102	1	330.00	
	1NO+1 NC	LS-102/ALS-102	1	330.00	
	2NO+1 NC/1 NO+2 NC	LS-102/3A/3B	1	410.00	
	2NO/2 NC	LS-102/2A/2B	1	365.00	
	Snap				
	1NO+1 NC	LSN-112	1	340.00	
	1NO+1 NC	ALS-112	1	340.00	
	b. With Push Rod Actuation				
	Normal				
	1NO+1 NC	LSN-101	1	300.00	
	1NO+1 NC	LS-101/ALS-101	1	300.00	
	2NO+1 NC/1 NO+2 NC	LS-101/3A/3B	1	380.00	
	1NO+1 NC	LS-101/2A/2B	1	330.00	
	Snap				
	1NO+1 NC	LSN-111	1	310.00	
	1NO+1 NC	ALS-111	1	310.00	
3	With Oil Tight Aluminium Housing				
	(Epoxy Powder Coated)				
	a. With Roller lever				
	Normal				
	1NO+1 NC	LSN-202	1	370.00	
	1NO+1 NC	LS-202/ALS-202	1	370.00	
	2NO+1 NC/1 NO+2 NC	LS-202/3A/3B	1	450.00	
	2NO/2 NC	LS-202/2A/2B	1	405.00	
	Snap				
	1NO+1 NC	LSN-212	1	380.00	
	1NO+1 NC	ALS-212	1	380.00	
	b. With Push Rod Actuation				
	Normal				
	1NO+1 NC	LSN-201	1	335.00	
	1NO+1 NC	LS-201/ALS-201	1	335.00	
	2NO+1 NC/1 NO+2 NC	LS-201/3A/3B	1	415.00	
	2NO/2 NC	LS-201/2A/2B	1	370.00	
	Snap				
	1NO+1 NC	LSN-211	1	345.00	
	1NO+1 NC	ALS-211	1	345.00	



®

CE

AVON SWITCHGEARS PVT. LTD.

AN ISO 9001 : 2015 CERTIFIED COMPANY

ITEMS	NO.	DESCRIPTION	TYPE	STD. PKD.	UNIT RATE (₹)
-------	-----	-------------	------	-----------	---------------

TYPE-LSN / LS / ALS



BRL/OT



ABRL/OT



BRL/201



P & RC



BRL/202



ABRL/202

4	Bracket Roller Assembly (For Limit Switch in Standard/Oil Tight Hsg.)	BRL/OT	25	65.00
5	Angular Bracket Roller Assembly (For Limit Switch in Standard/Oil Tight Hsg.)	ABRL/OT	25	80.00
6	Mounting Head (Metal)+ Pin & Rubber Cup	MH(M)/P & RC-201	25	135.00
7	Mounting Head (Plastic)+Pin & Rubber Cup	MH(P)/P & RC-201	25	120.00
8	Pin & Rubber Cup	P & RC-201	25	50.00
9	Mounting Head (Metal)	MH(M)-201	25	80.00
10	Mounting Head (Plastic)	MH(P)-201	25	65.00
11	Bracket Roller Assembly with Bult in Plastic Mounting Head (For Limit Switch Oil Tight Hsg.)	BRL/202	25	125.00
12	Angular Bracket Roller Assembly with Bult in Plastic Mounting Head (For Limit Switch Oil Tight Hsg.)	ABRL/202	25	135.00

TYPE-M (1 NO + 1 NC)



M-000
M-010



ML-01
ML-11



ML-02
ML-12



ML-0 TPR
ML-1 TPR



ML-0 WST/WSP/WCW
ML-1 WST/WSP/WCW



BRL-ML-02(M)

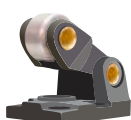

BRL-ML-02(P)

1	Contact Block (With Built Cover)			
	Normal	M-000	10	125.00
	Snap	M-010	10	135.00
2	With Mini Oil Tight Aluminium Housing (Epoxy Powder Coated)			
	a. With Roller lever			
	Normal	ML-02	5	315.00
	Snap	ML-12	5	325.00
	b. With Push Rod Actuation			
	Normal	ML-01	5	280.00
	Snap	ML-11	5	290.00
	c. With Top Push Roller			
	Normal	ML-0 TPR	5	300.00
	Snap	ML-1 TPR	5	310.00
	d. With Wobble Stick/ Wobble Spring/Cat Whisker			
	Normal	ML-0 WST/WSP/WCW	4	435.00
	Snap	ML-1 WST/WSP/WCW	4	445.00
3	Bracket Roller Assembly (Metal) for ML-02	BRL-ML-02(M)	25	80.00
4	Bracket Roller Assembly (Plastic) with S.S. Roller For ML-02	BRL-ML-02(P)	25	72.00

TYPE-C (1 NO+1 NC)



C-001



C-011

1	Open Execution (With Push Rod & Built in Cover)			
	Normal	C-001	10	155.00
	Snap	C-011	10	165.00



®

CE

AVON SWITCHGEARS PVT. LTD.

AN ISO 9001 : 2015 CERTIFIED COMPANY

ITEMS	NO.	DESCRIPTION	TYPE	STD. PKD.	UNIT RATE (₹)
-------	-----	-------------	------	-----------	---------------

TYPE-B (1 NO+1 NC)



B-010
B-000



B-010/FP
B-000/FP



B-302
B-312



B-301
B-311



B-3-0-OT
B-3-1-OT



B-304/30/38/76
B-314/30/38/76



B-314/30/38/76-RRL(40/50)
B-304/30/38/76-RRL(40/50)

UNDER DEVELOPMENT

B-304-YRL
B-314-YRL



B-304-ARL
B-314-ARL



B-314-ARRL(40/50)
B-304-ARRL(40/50)



B-304-ANT
B-314-ANT



B-3-0-TPR
B-3-1-TPR

1	Contact Block (With Built in Cover)				
	Normal	B-000	10	155.00	
	Snap	B-010	10	165.00	
2	Contact Block for Flame proof enclosures (With Built in Cover)				
	Normal	B-000/FP	10	155.00	
	Snap	B-010/FP	10	165.00	
3	With Wide Oil Tight Aluminium Housing (Epoxy Powder Coated)				
	a. With Roller lever				
	Normal	B-302	1	370.00	
	Snap	B-312	1	380.00	
	b. With Push Rod Actuation				
	Normal	B-301	1	330.00	
	Snap	B-311	1	340.00	
	c. With Crank Roller Lever-Over Trave Push Plunger				
	Normal	B-3-0-OT	1	650.00	
	Snap	B-3-1-OT	1	660.00	
	d. With Crank Roller Lever-Length 38mm/76mm				
	Normal	B-304/30/38/76	1	700.00	
	Snap	B-314/30/38/76	1	710.00	
	e. With Crank Rubber Roller Lever-Length 38mm/76mm (40/50mm dia.)				
	Normal	B-304/30/38/76-RRL(40/50)	1	750.00	
	Snap	B-314/30/38/76-RRL(40/50)	1	760.00	
	f. With Crank Roller Lever-Adjustable				
	Normal	B-304-ARL	1	700.00	
	Snap	B-314-ARL	1	710.00	
	g. With Crank York Roller Lever-Spring Return				
	Normal	B-304-YRL	1	910.00	
	Snap	B-314-YRL	1	920.00	
	h. With Crank York Roller Lever-Maintained				
	Normal	B-304-YRL	1	975.00	
	Snap	B-314-YRL	1	985.00	
	i. With Crank Rubber Roller Lever-Adjustable (40/50mm dia.)				
	Normal	B-304-ARRL(40/50)	1	750.00	
	Snap	B-314-ARRL(40/50)	1	760.00	
	j. With Crank Antena Lever				
	Normal	B-304-ANT	1	700.00	
	Snap	B-314-ANT	1	710.00	
	k. With Top Push Roller				
	Normal	B-3-0-TPR	1	700.00	
	Snap	B-3-1-TPR	1	710.00	
	l. With Top Push Button Adjustable				
	Normal	B-3-0-TPBA	1	700.00	
	Snap	B-3-1-TPBA	1	710.00	



®

CE

AVON SWITCHGEARS PVT. LTD.

AN ISO 9001 : 2015 CERTIFIED COMPANY

ITEMS	NO.	DESCRIPTION	TYPE	STD. PKD.	UNIT RATE (₹)
-------	-----	-------------	------	-----------	---------------

TYPE-B (1 NO+1 NC)

UNDER DEVELOPMENT

B-3-0-SPR
B-3-1-SPR

UNDER DEVELOPMENT

B-3-0-SPBA
B-3-1-SPBA

UNDER DEVELOPMENT

B-3-0-WST/WSP/WCW
B-3-1-WST/WSP/WCW



B-402
B-412



B-401
B-411



B-404/ 30/38/76
B-414/30/38/76



B-4-0-OT
B-4-1-OT



B-404-ARL
B-414-ARL

B-404/30/38/76-RRL(40/50)
B-414/30/38/76-RRL(40/50)

UNDER DEVELOPMENT

B-404-YRL
B-414-YRL



B-404-ARRL(40/50)
B-414-ARRL(40/50)



B-404-ANT
B-414-ANT



B-4-0-TPR
B-4-1-TPR

	m. With Side Push Roller				
	Normal	B-3-0-SPR	1	700.00	
	Snap	B-3-1-SPR	1	710.00	
	n. With Side Push Button Adjustable				
	Normal	B-3-0-SPBA	1	700.00	
	Snap	B-3-1-SPBA	1	710.00	
	o. With Wobble Stick/Wobble Spring/ Cat Whisker				
	Normal	B-3-0-WST/WSP/WCW	1	700.00	
	Snap	B-3-1-WST/WSP/WCW	1	710.00	
4	With Narrow Oil Tight Aluminium Housing (Epoxy Powder Coated)				
	a. With Roller lever				
	Normal	B-402	1	370.00	
	Snap	B-412	1	380.00	
	b. With Push Rod Actuation				
	Normal	B-401	1	330.00	
	Snap	B-411	1	340.00	
	c. With Crank Roller Lever- Length 38mm or 76mm				
	Normal	B-4-0-OT	1	650.00	
	Snap	B-4-1-OT	1	660.00	
	d. With Crank Roller Lever-Length 38mm/76mm				
	Normal	B-404/30/38/76	1	700.00	
	Snap	B-414/30/38/76	1	710.00	
	e. With Crank Rubber Roller Lever- Length 38mm/76mm (40/50mm dia.)				
	Normal	B-404/30/38/76-RRL(40/50)	1	750.00	
	Snap	B-414/30/38/76-RRL(40/50)	1	760.00	
	f. With Crank Roller Lever-Adjustable				
	Normal	B-404-ARL	1	700.00	
	Snap	B-414-ARL	1	710.00	
	g. With Crank York Roller Lever-Spring Return				
	Normal	B-404-YRL	1	910.00	
	Snap	B-414-YRL	1	920.00	
	h. With Crank York Roller Lever- Maintained				
	Normal	B-404-MYRL	1	975.00	
	Snap	B-414-MYRL	1	985.00	
	i. With Crank Roller Lever-Adjustable (40/50mm dia.)				
	Normal	B-404-ARRL(40/50)	1	750.00	
	Snap	B-414-ARRL(40/50)	1	760.00	
	j. With Crank Antenna Lever				
	Normal	B-404-ANT	1	700.00	
	Snap	B-414-ANT	1	710.00	
	k. With Top Push Roller				
	Normal	B-4-0-TPR	1	700.00	
	Snap	B-4-1-TPR	1	710.00	
	l. With Top Push Button Adjustable				
	Normal	B-4-0-TPBA	1	700.00	
	Snap	B-4-1-TPBA	1	710.00	



®

CE

AVON SWITCHGEARS PVT. LTD.

AN ISO 9001 : 2015 CERTIFIED COMPANY

ITEMS	NO.	DESCRIPTION	TYPE	STD. PKD.	UNIT RATE (₹)
-------	-----	-------------	------	-----------	---------------

TYPE-B (1 NO+1 NC)

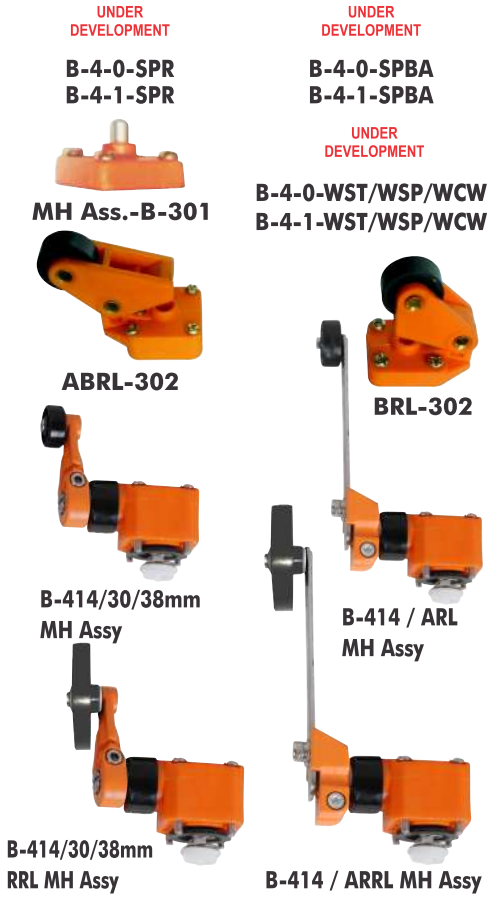

		m. With Side Push Roller			
		Normal	B-4-0-SPR	1	700.00
		Snap	B-4-1-SPR	1	710.00
		n. With Side Push Button Adjustable			
		Normal	B-4-0-SPBA	1	700.00
		Snap	B-4-1-SPBA	1	710.00
		o. With Wobble Stick/Wobble Spring/ Cat Whisker			
		Normal	B-4-0-WST/WSP/WCW	1	700.00
		Snap	B-4-1-WST/WSP/WCW	1	710.00
5		Mounting Head+Pin & Rubber Cup for B-#01/#11	MH Ass.-B-301	25	62.00
6		Pin & Rubber Cup	P & RC-B-301	25	40.00
7		Mounting Head for B-#01/#11	MH-B-301	25	36.00
8		Bracket Roller Assembly (For Limit Switch In Wide /Narrow Oil Tight Hsg.)	BRL-302	25	68.00
9		Angular Bracket Roller Assembly (For Limit Switch In Wide /Narrow Oil Tight Hsg.)	ABRL-302	25	90.00
10		B-414 / 30/38mm Mounting Assembly	B-414 / 30/38mm MH Assy	12	410.00
11		B-414 / ARL Mounting Assembly	B-414 / ARL MH Assy	12	410.00
12		B-414 / 30/38mm RRL Mounting Assembly	B-414 / 30/38mm RRL MH Assy	6	450.00
13		B-414 / ARRL Mounting Assembly	B-414 / ARRL MH Assy	6	450.00

TYPE-AELS (A NO / B NC)



1		Elevator Final Limit Switch	AELS-B(NC)	1	285.00
					Net
1		Elevator Final Limit Switch	AELS-A(NO)	1	285.00
					Net

All other Mounting Head assemblies are available separately. Prices on request only.

The Above prices are with Plastic Roller. For M.S. Roller add. Rs. 15=00 per pc. and for S.S. Roller add. Rs. 60=00

NOTES

Terms and Conditions -

1. This Price-List supersedes all previous Price-Lists.
2. Prices are subject to change without prior notice.
3. Prices are Maximum Retail Prices for Sale across India only.
4. All Technical Specifications may be confirmed before ordering.
5. Design modifications may take place in view of continuing R & D activities
6. Payment 100% against delivery or through Bank or PDC.
7. Subjected to Mumbai Jurisdiction only.

DEALERS